

5120 GOLDLEAF CIRCLE

Suite 310 - 3,429-6,619 SF

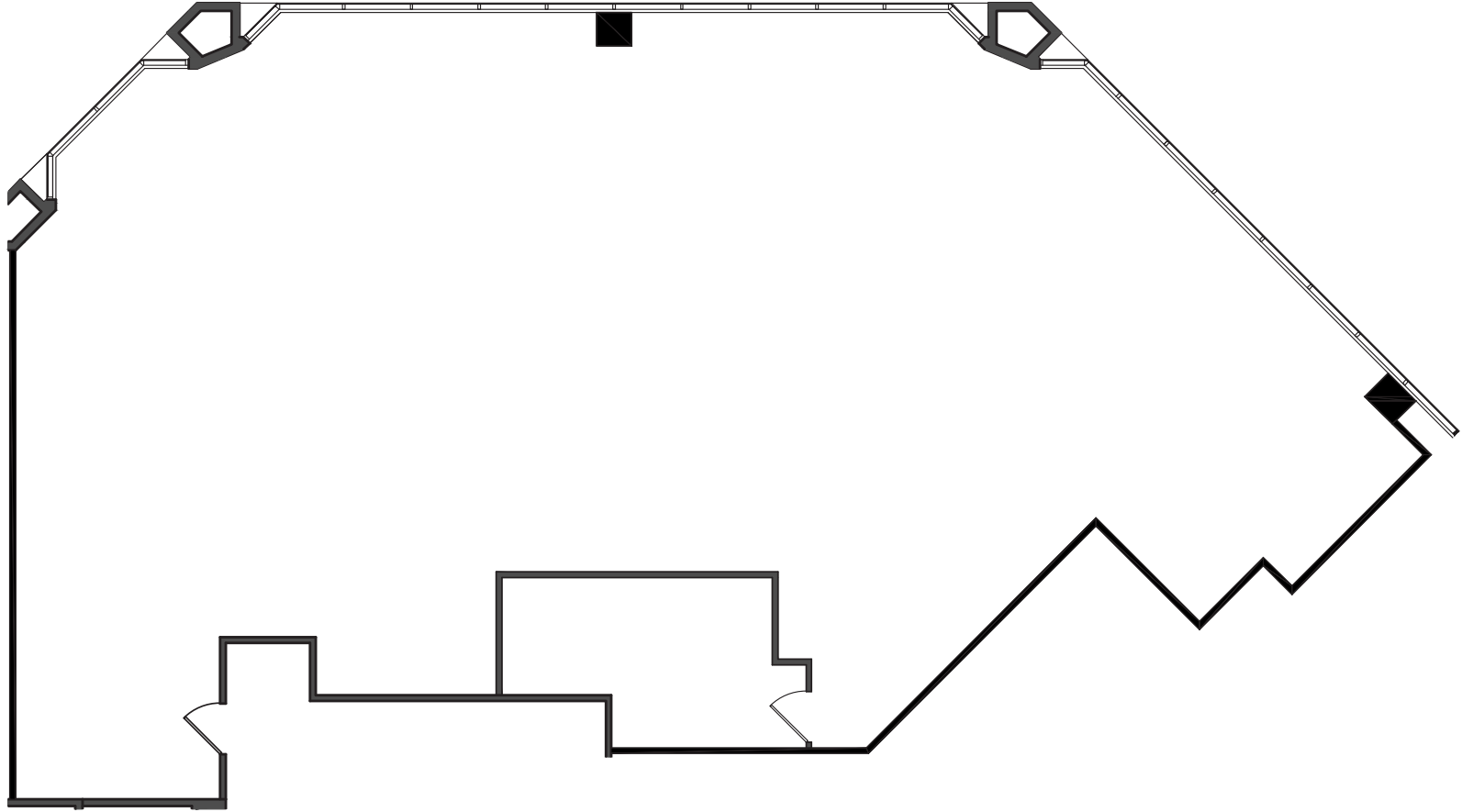

Wateridge.LA

**FOR OFFICE LEASING INFORMATION,
PLEASE CONTACT:**

**FOR RETAIL LEASING INFORMATION,
PLEASE CONTACT:**

LPCWEST
LINCOLN PROPERTY COMPANY

KENT S. HANDLEMAN
khandleman@lpc.com
213 542 8246

DOUGLAS J. BROWN
dbrown@lpc.com
213 542 8247

RICK BUCKLEY
rbuckley@lrealtypartners.com
310 407 3422

ZACHARY A. CARD
zachary.card@cbre.com
310 550 2542

